

WALL SPLICE OPTION - B

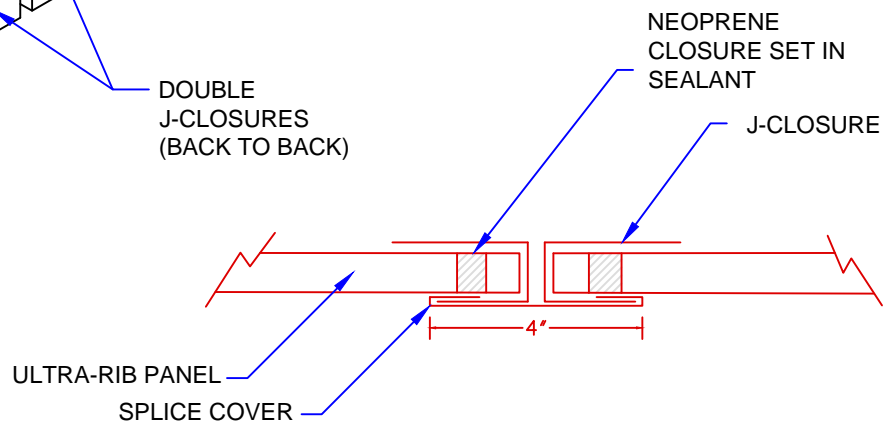

|               |                       |      |
|---------------|-----------------------|------|
| PROJECT NAME: | WALL SPLICE OPTION #B |      |
| LOCATION:     | PROJECT NO.:          | UR2B |
| CONTRACTOR:   | DATE:                 |      |



COATED METALS GROUP  
WWW.CMGMETALS.COM

CORPORATE HEADQUARTERS:  
300 YARD DRIVE  
VERONA, WISCONSIN 53593  
TOLL FREE: 800-784-0356